

Calvary Early Learning Center
4725 Old William Penn Highway
Murrysville, PA 15668-2012
724-327-2898

Dear Parents or Guardians:

Thank you for your interest in Calvary Early Learning Center for your child's kindergarten experience. Please spend a few minutes looking over the pdfs in the email you received. If you need to fill anything out, you may type them directly on the fillable pdfs. Remember to save each form before going on to the next one. If your signature is required, you may include a jpeg of your signature. When all forms are complete you have two options.

1. You may print out your forms at home, include your signature as needed, and return them to the school office with your \$75 registration fee. Your child will be registered that day.
2. You may attach the completed documents and email the forms to CELCMurrysville@gmail.com. I will print them at school, but your child's registration will not be complete until you send in the \$75 registration fee.

You should find:

- An Application for Enrollment,
- An Emergency Form,
- A Tuition Rate List,
- A School Calendar,
- A Curriculum Guide,
- A Tuition Policy and Parent Agreement of Support Form (2 copies),
- A Consent, Waiver, and Release of Liability Form,
- A Textbook Loan Form,
- A Family Dentist Report,
- An Immunization Form, and
- Information on Clearances.

Please spend a few minutes looking over this important information. If you have any questions, or if you would like to set up a tour of our facility, please call 724-327-2898. I will be happy to help you.

The *Immunization* and *Family Dentist* forms will need to be filled out by your child's pediatrician and dentist and returned by October 15. **The first tuition payment is due on September 1st.** (You can save 3% on the total if you pay the entire sum by August 15th.)

Calvary Early Learning Center staff communicates in many ways with its students' parents. Once your child is enrolled, you will receive an *ABC's of Kindergarten* handbook that lists the school's policies and procedures and other pertinent data. The teacher also sends home a weekly newsletter to let you know what activities your child will be participating in that week. The school/church website www.calvarylms.org has information posted during the school year. Calvary Early Learning Center also has a page on Facebook. Please check them out.

Thank you again for your interest in Calvary Early Learning Center for your child's kindergarten experience. If you have any questions, please don't hesitate to contact me at 724-327-2898 or at CELCMurrysville@gmail.com.

In His Service,

A handwritten signature in cursive script that reads "Laura R. Hoff".

Laura R. Hoff
Administrator

Enclosures

NOTICE OF NONDISCRIMINATION

Calvary Early Learning Center admits students of any race, color, national or ethnic origin, or religious affiliation, to all rights, privileges, programs and activities available to students at the school. It does not discriminate on the basis of gender, race, creed, color, or national or ethnic origin in administration of its education policies, scholarship, or other school-administered programs.



Calvary Early Learning Center Registration for 2025-2026

January 20, 2025

Dear CELC Families,

We have advertised Calvary Early Learning Center as *The best kept secret in Murrysville*. We don't want to keep it a secret any longer, and we need your help.

- Registration opens to you, our current families next week during Lutheran Schools Week, so that you have first chance at reserving a spot for your child's next class. You know that our \$75 Registration Fee is nonrefundable. **However, if you register your child before March 31, 2025, we will deduct the \$75 off of your August full-tuition payment or your September tuition payment.**

We have long believed that our best advertisement is *word of mouth* from those who know us best, and we are going to reward you for sharing our secret.

- When a new family enrolls a child in either **the Fours, PreK, or Kindergarten class** because of your recommendation, we will **deduct 20%** off of your monthly tuition for each month the referred child attends CELC.
- If you tell **two** new families about CELC, and they both enroll a child in either the Fours, PreK, or Kindergarten classes because of your recommendation, we will **deduct 40%** off of your monthly tuition for each month the referred child attends CELC, and so on.
- **If your recommendations bring five new families to our 4s, PreK, or K classes, your tuition will be FREE!**

How will this work?

There is a question on the second page of our Application Form:

How did you hear about CELC?

The parent filling out the Enrollment Application needs to name you. Each time a new child is enrolled in one of the classes listed above **and answers this question with your name**, we will mark your account. As long as the child(ren) remain enrolled during the 2025 - 2026 school year, you will receive a monthly tuition deduction of **20% X the number of referrals**.

If you have questions, feel free to contact Laura Hoff.



Calvary Early Learning Center

Application for Enrollment 2025-2026

STUDENT INFORMATION

Name (Last, First, Middle):

Age: Sex: Male Female Birthday:

Address:

City

State

Zip Code

Home Phone:

Email:

Marital Status of Parents: Married Living Together Separated Divorced Grandparent

Custody/visiting arrangement, if applicable:

School Last Attended:

FAMILY INFORMATION

Father's Name:

Occupation:

Employer:

Business Phone:

Father's Cell Phone:

Accepts Texts? Y N

Mother's Name:

Occupation:

Employer:

Business Phone:

Mother's Cell Phone:

Accepts Texts? Y N

Name and Ages of Siblings:

ENROLLMENT INFORMATION

Please check the Program for which you are registering:

3 Year-Old (Tu-Th)		3 Year-Old (M-W-F)		Four Year-Old Program	
--------------------	--	--------------------	--	-----------------------	--

Pre-Kindergarten	
------------------	--

Kindergarten (M-F)		Kindergarten Only: Will you require busing?	No	Yes:	a.m.		p.m.
--------------------	--	---	----	------	------	--	------

Name of Home School District:



Emergency Information 2025-2026

Child's Name			Date of Birth
Last	First	Nickname	Home Phone
Street Address			
City	State	Zip code	
Mother or Guardian (Include maiden name)			Cell
Employment	Hours:	Work	
Father or Guardian Name			Cell
Employment	Hours:	Work	
Parent/Guardian Email Address			

Persons authorized to pick up child:

No child will be released to anyone not known to the school without authorization from parents or guardian.

Person to be called in case of emergency

(Be sure to include someone who will usually know your whereabouts)

Name	Relationship to child	
Address	Phone	
City	State	Zip code
Name	Relationship to child	
Address	Phone	
City	State	Zip code
Child's Physician	Phone	

Emergency Hospital preference _____

I authorize the school to give my child Tylenol, if needed

Parent or Guardian Signature _____

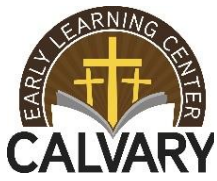

Calvary Early Learning Center 2025-2026 Tuition Rates

New
Class!!!

Threes

Tuesday, Thursday

9:00 - 11:30 am

Registration, which includes Materials Fee

\$75

Tuition

\$1350/year
\$150 month*
\$1309.50**
\$1234.50***

Threes

Monday, Wednesday, Friday

9:00 - 11:30 am

Registration, which includes Materials Fee

\$75

Tuition

1980/year
\$220 month*
\$1920.60**
\$1845.60***

Fours

Monday, Wednesday, Friday

9:00 - 11:30 a.m.

Registration, which includes Materials Fee

\$75

Tuition

\$1980/year
\$220/Month*
\$1920.60**
\$1845.60***

PreK

Monday - Thursday

12:30 - 3:00 pm

Registration, which includes Materials Fee

\$75

Tuition

\$2340/year
\$260/month*
\$2269.80**
\$2194.80***

Kindergarten

Monday-Friday 9:00 a.m. - 2:00 p.m.

Registration, which includes Materials Fee: \$75

Tuition:

\$3240/year
\$360/month*
\$3142.80**
\$3067.80***

Because our class-sizes are small, the Registration Fee is required to reserve a child's place in a particular class. CELC will purchase materials for that child's education, so the Registration Fee is non-refundable. However, if you complete your child's registration on or before March 31st, you will receive a \$75 deduction off your September tuition payment or off the total if paid by August 15th.

*Total tuition divided into 9 monthly payments from September 1 to May 1

**reflects 3% discount if total tuition is paid in full by Friday, August 15, 2025.

***reflects 3% discount AND \$75 Registration Fee Deduction if registration was completed by March 31st AND total tuition is paid in full by Friday, August 15, 2025.

August

Su	M	Tu	W	Th	F	Sa
17	18	19	20	21	22	23
24	25	26	27	28	29	30
31						

20: First Day of School for Kindergarten
28: Preschool Orientation

September

Su	M	Tu	W	Th	F	Sa
	1	2	3	4	5	6
7	8	9	10	11	12	13
14	15	16	17	18	19	20
21	22	23	24	25	26	27
28	29	30				

1: Labor Day; NO SCHOOL
2: 1st Day for 3s and PreK
3: 1st Day for 3s and 4s
School Pictures (To be announced)

October

Su	M	Tu	W	Th	F	Sa
			1	2	3	4
5	6	7	8	9	10	11
12	13	14	15	16	17	18
19	20	21	22	23	24	25
26	27	28	29	30	31	

1: Cruising with CELC Fundraiser
13: Columbus Day; NO SCHOOL
24: First Quarter Ends (46 days)
30: Harvest Party for 3s and PreK
31: Harvest Party for 3s, 4s, and K

November

Su	M	Tu	W	Th	F	Sa
						1
2	3	4	5	6	7	8
9	10	11	12	13	14	15
16	17	18	19	20	21	22
23	24	25	26	27	28	29
30						

26: NO SCHOOL
27: Thanksgiving; NO SCHOOL
28: Thanksgiving Break, NO SCHOOL

December

Su	M	Tu	W	Th	F	Sa
	1	2	3	4	5	6
7	8	9	10	11	12	13
14	15	16	17	18	19	20
21	22	23	24	25	26	27
28	29	30	31			

12: Christmas Program; 10 am
17: Christmas Party for 3s
18: Christmas Party for PreK
19: Christmas Party for 4s and K
19: Early Dismissal for K; 11:30 a.m.
20 - Jan. 4: Christmas Break;
NO SCHOOL 14

January

Su	M	Tu	W	Th	F	Sa
				1	2	3
4	5	6	7	8	9	10
11	12	13	14	15	16	17
18	19	20	21	22	23	24
25	26	27	28	29	30	31

1-2: NO SCHOOL
5: School Resumes
16: Second Quarter Ends (46 Days)
19: Martin Luther King, Jr. Day; NO SCHOOL
25-31: National Lutheran Schools Week

February

Su	M	Tu	W	Th	F	Sa
1	2	3	4	5	6	7
8	9	10	11	12	13	14
15	16	17	18	19	20	21
22	23	24	25	26	27	28

12: Valentine's Day Parties: 3s and PreK
13: Valentine's Day Parties: 3s, 4s, and K
16: Presidents' Day; NO SCHOOL
18: Ash Wednesday

March

Su	M	Tu	W	Th	F	Sa
1	2	3	4	5	6	7
8	9	10	11	12	13	14
15	16	17	18	19	20	21
22	23	24	25	26	27	28
29	30	31				

8: Daylight Savings Begins
20: Early Dismissal Kindergarten
20: Third Quarter Ends (43 Days)
29: Palm Sunday
31: Easter Parties; 3s

April

Su	M	Tu	W	Th	F	Sa
			1	2	3	4
5	6	7	8	9	10	11
12	13	14	15	16	17	18
19	20	21	22	23	24	25
26	27	28	29	30		

1: Easter Parties; 3s, 4s, PreK, and K
2: Maundy Thursday; NO SCHOOL
3: Good Friday; NO SCHOOL
5: Easter Sunday
6: Easter Monday; NO SCHOOL
24: Spring Program; 10 a.m.

May

Su	M	Tu	W	Th	F	Sa
					1	2
3	4	5	6	7	8	9
10	11	12	13	14	15	16
17	18	19	20	21	22	23
24	25	26	27	28	29	30
31						

20: Preschool Graduation
25: Memorial Day; NO SCHOOL
29: Kindergarten Graduation 11:00 a.m.
29: Fourth Quarter Ends (46 Days)



Immunization Form

Due: October 1, 2025

Name _____ Birthdate _____

Address _____ Parent or guardian _____

Telephone _____

Race/ethnicity: White Black Asian or Pacific Islander American Indian or Alaskan Native
 Hispanic origin: Yes No

Please circle present class: Twos Threes Fours PreK K

PENNSYLVANIA DEPARTMENT OF HEALTH – CERTIFICATE OF IMMUNIZATION

VACCINE Circle appropriate item	Enter month, day, and year when immunization doses listed below were given.				
Diphtheria, tetanus and acellular pertussis (DTaP, DTP, Td or DT)	1 / /	2 / /	3 / /	4 / /	5 / /
Tetanus, diphtheria and acellular pertussis (Tdap)	1 / /	2 / /	3 / /	4 / /	5 / /
Polio (OPV or IPV)	1 / /	2 / /	3 / /	4 / /	5 / /
Hepatitis B	1 / /	2 / /	3 / /	4 / /	5 / /
Measles - mumps - rubella (MMR)	1 / /	2 / /	or Measles serology Date _____ Titer _____		
Varicella (vaccine or disease)	1 / /	2 / /	Rubella serology Date _____ Titer _____		
Meningococcal (MCV)	1 / /	2 / /			
Other	1 / /	2 / /	Mumps disease diagnosed by a physician: Date _____		

H502.320 Rev. 03/17

Name _____ Birthdate _____

Address _____ Parent or guardian _____

Telephone _____

Please circle present class: Twos Threes Fours PreK K

STATEMENT OF EXEMPTION TO IMMUNIZATION LAW

MEDICAL EXEMPTION

The physical condition of the above-named child is such that immunization would endanger life or health.

Signed _____ Date _____
(PHYSICIAN)

RELIGIOUS EXEMPTION

State your reason for requesting this exemption.

PHILOSOPHICAL/STRONG MORAL OR ETHICAL CONVICTION EXEMPTION

State your reason for requesting this exemption.

Signed _____
(PARENT OR GUARDIAN) (Date)

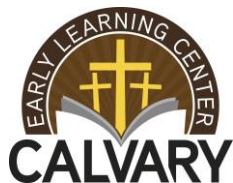

Calvary Early Learning Center

4725 Old William Penn Highway

Murrysville, PA 15668

724-327-2898

TUITION POLICY AND PARENTS' AGREEMENT OF SUPPORT

The undersigned parents agree to pay a total of \$_____ for the 2025-2026 school year in Nine (9) equal monthly payments beginning on or before the close of business on **September 1st**.

- Tuition payments are **due on or before close of business on the 1st calendar day of each month**. Tuition is paid on a **9-month schedule from September through May**, with payments beginning the month the school year starts and ending 1 month before the school year ends.
- Checks are to be made payable to **Calvary Early Learning Center** and dropped off in the school office or mailed directly to CELC; 4725 Old William Penn Highway, Murrysville, PA 15668.
- Checks returned for insufficient funds will be assessed a penalty of \$15, in addition to any fees imposed by the issuing bank.
- **A \$10 late fee will be assessed for any payment received after close of business on the 5th calendar day of the month. Late fees will accumulate monthly at \$10 each month until payment is received.**
- Children will not be able to attend class if a tuition payment is not made by the 10th calendar day of the month until the past due amount (including the \$10 penalty) has been paid.
- Parents receive a 3% discount on the cost of tuition if the total year's tuition is paid in full by the 15th calendar day of August.
- Staff members will receive a 20% discount on the cost of tuition for their child(ren) to attend school.
- Any child from a clergyman's family will receive a 20% discount on the cost of tuition.*
- Families with more than one child attending the school will receive a 10% discount on the tuition cost for the second (third or fourth) child.*
- *Only one discount can be applied per child. (Either the clergy discount or the additional child; not both.)
- **Parents are encouraged to make every effort to pay tuition on time.** For circumstances requiring special consideration, parents can speak with the Administrator in confidence. The Administrator will make every reasonable effort to reach an agreement that is in the best interest of all concerned parties.

Our signature indicates that we have read, understand, and agree to the terms as stated above in the Tuition Policy.

Parent's signature

Date

Printed name

Parent's signature

Date

Printed name

PARENTS ARE TO SIGN 2 COPIES – 1 FOR THE SCHOOL & 1 FOR THEIR RECORDS

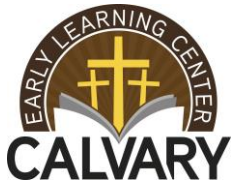

Calvary Early Learning Center
 4725 Old William Penn Highway
 Murrysville, PA 15668
 724-327-2898

TUITION POLICY AND PARENTS’ AGREEMENT OF SUPPORT

The undersigned parents agree to pay a total of \$_____ for the 2025-2026 school year in Nine (9) equal monthly payments beginning on or before the close of business on **September 1st**.

- Tuition payments are **due on or before close of business on the 1st calendar day of each month**. Tuition is paid on a **9-month schedule from September through May**, with payments beginning the month the school year starts and ending 1 month before the school year ends.
- Checks are to be made payable to **Calvary Early Learning Center** and dropped off in the school office or mailed directly to CELC; 4725 Old William Penn Highway, Murrysville, PA 15668.
- Checks returned for insufficient funds will be assessed a penalty of \$15, in addition to any fees imposed by the issuing bank.
- **A \$10 late fee will be assessed for any payment received after close of business on the 5th calendar day of the month. Late fees will accumulate monthly at \$10 each month until payment is received.**
- Children will not be able to attend class if a tuition payment is not made by the 10th calendar day of the month until the past due amount (including the \$10 penalty) has been paid.
- Parents receive a 3% discount on the cost of tuition if the total year’s tuition is paid in full by the 15th calendar day of August.
- Staff members will receive a 20% discount on the cost of tuition for their child(ren) to attend school.
- Any child from a clergyman’s family will receive a 10% discount on the cost of tuition.*
- Families with more than one child attending the school will receive a 20% discount on the tuition cost for the second (third or fourth) child.*
- *Only one discount can be applied per child. (Either the clergy discount or the additional child; not both.)
- **Parents are encouraged to make every effort to pay tuition on time.** For circumstances requiring special consideration, parents can speak with the Administrator in confidence. The Administrator will make every reasonable effort to reach an agreement that is in the best interest of all concerned parties.

Our signature indicates that we have read, understand, and agree to the terms as stated above in the Tuition Policy.

 Parent’s signature

 Date

 Printed name

 Parent’s signature

 Date

 Printed name

PARENTS ARE TO SIGN 2 COPIES – 1 FOR THE SCHOOL & 1 FOR THEIR RECORDS

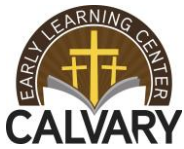

Calvary Early Learning Center
Consent, Waiver and Release of Liability Form 2025-2026

I, _____, hereby certify that I am the Parent or Legal
Guardian of the minor child: _____

I hereby consent for my child to attend Calvary Early Learning Center and participate in all activities sponsored by Calvary Early Learning Center. I have inspected the premises and consulted with Calvary Early Learning Center employees, including teachers and instructors. I have determined that the premises are safe and I consent to leave my child in the care and custody of Calvary Early Learning Center. I hereby grant permission for my child to use all of the play equipment and participate in all of the activities of the school. I hereby grant permission for my child to leave the school premises under the supervision of a staff member for neighborhood walks or for field trips in an authorized vehicle. I hereby grant permission for my child to be included in evaluations connected with the school program.

I represent that my child is properly immunized against all childhood diseases or illnesses. I represent that I have advised Calvary Early Learning Center staff regarding any allergies or physical disabilities that my child may have. I agree to indemnify and hold Calvary Early Learning Center, its directors, employees, and agents harmless against any and all claims arising from injury or illness my child may suffer as the result of food allergies or disabilities that I previously disclosed to Calvary Early Learning Center, or food allergies or disabilities that I had knowledge of but did not disclose.

I represent that my child has health insurance coverage and I agree that I will maintain said coverage during the entire time my child attends or participates at Calvary Early Learning Center. I have been advised that Calvary Early Learning Center does not provide health insurance or medical coverage to my child, in any form, under any circumstances.

I agree to indemnify and hold Calvary Early Learning Center its directors, employees and agents harmless against any and all claims arising as a result of my child attending and/or participating in the activities of Calvary Early Learning Center.

I authorize Calvary Early Learning Center and its directors, employees and agents to provide first aid care, or emergency medical care to my child and/or to obtain such emergency medical care for my child as may appear reasonably necessary in my absence, including emergency transportation to a hospital. I agree to be financially responsible for any and all medical expenses or costs that are incurred in treating my child for illness or injury when said illness or injury arises as while my child is on the premises of or in the custody of Calvary Early Learning Center.

I CERTIFY THAT I HAVE READ THE ABOVE AGREEMENT AND AGREE TO THE TERMS THEREOF.

Parent's signature

Date

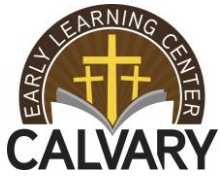

CLEARANCES

Our staff and school board members have their clearances on file. In accordance with the law, if you would like to volunteer as a Homeroom Mom/Dad or with any of our classroom parties, we need you to provide copies of the following Clearances:

CY 113 - Pennsylvania Child Abuse History Clearance

SP 4-164 - Request for Criminal Record Check

Thank you for your cooperation. These forms are available online at the PA Child Welfare Portal or at, <http://keepkidssafe.pa.gov/resources/clearances/index.htm>. You may request copies in the school office.

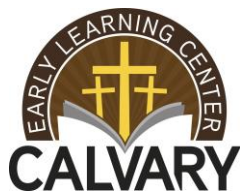

Calvary Early Learning Center
4725 Old William Penn Highway
Murrysville, PA 15668
724-327-2898
www.calvarylcms.org

January 2025

Dear Parent or Guardian:

The Secretary of Education, pursuant to Section 9-923-A of the Public School Code is authorized to purchase textbooks, instructional materials, and equipment, which may be loaned to all children residing in the Commonwealth who are enrolled in kindergarten through grade 12 in non-public and private schools. Our school is now in the process of requesting specific textbooks, materials and equipment to be loaned to your child(ren).

In order to participate in the program, a parent or guardian of each child attending the non-public or private school must individually request a loan of textbooks, instructional materials and equipment. Please sign the form below, date it, and return it to the school immediately.

Thank you for your continued assistance and cooperation.
Sincerely,

Laura R. Hoff

CERTIFICATE OF INDIVIDUAL REQUEST FOR LOAN OF TEXTBOOKS,
INSTRUCTIONAL MATERIALS AND EQUIPMENT

I hereby request the loan of textbooks, instructional materials and equipment in accordance with the Pennsylvania Public School Code of 1949 for my child(ren) attending Calvary Early Learning Center in Murrysville, PA.

Date

Signature of Parent or Guardian

This program is available to Pennsylvania residents.
(This form is to remain on file in the Calvary Early Learning Center office.)

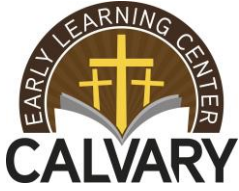

**Calvary Early Learning Center
Murrysville, PA
FAMILY DENTIST REPORT**

(Pennsylvania requires a Family Dentist Report upon entrance to Kindergarten)

Parents Complete This Section:

Name of Child Last First Middle	School Calvary Early Learning Center	Due Date October 15, 2025
Home Address	Zip Code	Home Phone Number

Dentist will complete this Section:

The above named child last visited my office on _____ (give date).

At that time all necessary dental corrections had been made. Yes No

If the answer above is "No" fill in the following:

This child is in need of treatment for one or more of the following:

Primary teeth _____ Fillings Extractions

Permanent teeth _____ Fillings Extractions

Diseases of the Supporting Tissues _____

Gross malocclusion which is producing a facial deformity or is interfering with function

Cleft palate and/or cleft lip Other congenital malformations

Prosthetic replacements for lost or missing teeth _____

This child is currently under treatment _____ Yes No

Signature _____ **D.D.S.**

Date Submitted _____ Address _____



CELC Kindergarten Curriculum Guide

Calvary Early Learning Center
4725 Old William Penn Highway
Murrysville, PA 15668
724-327-2898
CELCMurrysville@gmail.com

The curriculum used in the Kindergarten educational program at Calvary Early Learning Center is approved by the Commonwealth of Pennsylvania and is in line with the standards set for Kindergarten students. Students will have written assignments, quizzes, and tests in all academic subjects.

The mission of Calvary Early Learning Center is to share God's grace through the education and enrichment of young children, so the Kindergarten curriculum also includes daily Bible lessons (Jesus' Time) with prayer and memory work.

JESUS' TIME

The curriculum for Jesus' Time includes 36 Bible stories. The class focuses on one Bible story per week with different teaching strategies and activities that reinforce the lesson each day.

1. God Created the World
2. God Created People
3. The Garden Is Closed
4. Noah and the Flood
5. God Blesses Abraham
6. Isaac Is Born
7. Jacob Lies and Runs Away
8. Joseph and His Brothers
9. Moses
10. God's Law and the Golden Calf
11. The Battle of Jericho
12. David and Goliath
13. The Fiery Furnace
14. The Birth of John the Baptist
15. The First Christmas
16. The Wise Men Visit Jesus
17. Jesus in the Temple
18. Jesus Chooses His Disciples
19. Jesus at the Wedding at Cana
20. Jesus Calms the Storm
21. Jesus Blesses the Children
22. Jesus and Nicodemus
23. Jesus Heals Ten Men
24. Jesus Heals a Paralyzed Man
25. Jesus Feeds 5,000 People
26. Jesus with Mary and Martha
27. Jesus Rides into Jerusalem
28. Jesus Prays in the Garden
29. Jesus Is Crucified
30. Jesus Rises from the Dead
31. Thomas Sees Jesus
32. Jesus Ascends to Heaven
33. Pentecost
34. Paul's Ministry
35. Philip and the Ethiopian
36. Lydia



READING

The curriculum for reading is a combination of Harcourt School Publishers *Storytown* (©2008) and Sadlier *From Phonics to Reading*. Students will use phonics and high frequency words to begin to read. The lessons overlap, which provides for introduction and subsequent review of letters/sounds and high frequency words. Stories and activities will be based on the theme.

Storytown

Theme 1: *All About Me*

Phonics Skills: Consonant /m/, Consonant /s/, Consonant /r/, Consonant /t/
High Frequency words: *I, can, a, my*

Theme 2: *Families*

Phonics Skills: Consonant /n/, Consonant /p/, Consonant /c/, Short Vowel /a/
High Frequency words: *the, go*

Theme 3: *Friends at School*

Phonics Skills: Consonant /d/
High Frequency words: *to, like, he*

Theme 4: *On the Farm*

Phonics Skills: Short Vowel /i/, Consonant /g/, Consonant /f/
High Frequency Words: *come, here, this*

Theme 5: *Whatever the Weather*

Phonics Skills: Consonant /b/, Consonant /k/, Short Vowel /o/
High Frequency Words: *me, for, where, do, you, look*

Theme 6: *Let's Play*

Phonics Skills: Consonant /l/, Consonant /h/, Consonant /w/, Consonant /ks/ (x)
High Frequency Words: *one, see, what, two*

Theme 7: *In the Neighborhood*

Phonics Skills: Short Vowel /e/
High Frequency Words: *up, down, we, want, out, who*

Theme 8: *Jobs People Do*

Phonics Skills: Consonant /v/, Consonant /j/, Consonant /y/, Consonant /z/
High Frequency Words: *are, they, she, good*

From Phonics to Reading

Unit 1: Short a

Lesson 1: Mm, Alphabet Uppercase Letters

Lesson 2: Short a, Alphabet Lowercase Letters; High Frequency Words: I, can

Lesson 3: Ss, Uppercase and Lowercase Letters; High Frequency Words: see, a

Lesson 4: Tt, Match Uppercase and Lowercase Letters; High Frequency Words, the, on

Lesson 5: Pp, Match Uppercase and Lowercase Letters; High Frequency Words: like, to

Unit 2: Short i

Lesson 6: Nn, High Frequency Words: is, it

Lesson 7: Short i, High Frequency Words: big, little

Lesson 8: Cc, High Frequency Words: my, good

Lesson 9: Ff, High Frequency Words, yes, no

Lesson 10: Dd, High Frequency Words: look, he

Unit 3: Short o

Lesson 11: Hh, High Frequency Words: do, you

Lesson 12: Short o, High Frequency Words: what, this

Lesson 13: Rr, High Frequency Words: and, under

Lesson 14: Bb, High Frequency Words, or, are

Lesson 15: Ll, High Frequency Words: up, down

Unit 4: Short e

Lesson 16: Kk, High Frequency Words: she, her

Lesson 17: Short e, High Frequency Words: make, they

Lesson 18: Gg, High Frequency Words: where, with

Lesson 19: Ww, High Frequency Words, we, play

Lesson 20: Xx, High Frequency Words: one, have

Unit 5: Short u

Lesson 21: Vv, High Frequency Words: go, hurt

Lesson 22: Short u, High Frequency Words: day, of

Lesson 23: Jj, High Frequency Words: said, that

Lesson 24: Qu, High Frequency Words, there, out

Lesson 25: Yy, High Frequency Words: all, read

Unit 6: Introduction to Long Vowels

Lesson 26: Zz, High Frequency Words: for, finds

Lesson 27: Short Vowel Review; High Frequency Words: was, too

Lesson 28: Single Letter Long Vowels, e, i, o, High Frequency Words: come, some

Lesson 29: Final e (a_e), High Frequency Words: your, very

Lesson 30: Final e (o_e), (i_e), High Frequency Words: use, blue

Students will learn to write manuscript letters according to the
Zaner-Bloser Handwriting System using three guidelines:

Mathematics Horizons

The Horizons Kindergarten Math program includes lessons that introduce a concept for several days and is then reviewed systematically throughout the year to promote mastery of the concept. The following concepts will be taught during the year, but not necessarily in this order.

1: *Counting 1-100*

Counting by 1's, 5's, 10's, 2's, 3's, and 4's to 100.

2: *Number Recognition*

Recognition of all families to 100



3: *Number Writing*

Writing of all families to 100

4: *Number Value*

Value of all single digit numbers

5: *Number After*

Naming the number that comes after for all families to 100

6: *Number Before*

Naming the number that comes before for all families to 100

7: *Number Between*

Naming the number that comes between two numbers for all families to 100

8: *Place Value*

Ones, Tens

9: *Addition*

Adding a single digit to all families without regrouping

10: *Subtraction*

Subtracting a single digit from all families without regrouping

11: *Money*

Recognition, value, and use of the penny, nickel, dime, quarter, half-dollar, dollar bill, and dollar coin.

12: *Time*

Naming time on the hour, half-hour, quarter-hour, and 5 minutes

13: *Calendar*

Naming the days of the week, the months of the year, and the seasons

Mathematics Horizons

The Horizons Kindergarten Math program includes lessons that introduce a concept for several days and is then reviewed periodically throughout the year to better promote mastery of the concept.

14: *Number Theory*

Recognition of ordinal numbers, even and odd numbers

15: *Colors*

Recognition of black, yellow, green, red, blue, brown, orange, and purple

16: *Shapes*

Recognition of: circles, squares, triangles, rectangles, diamonds, stars, hexagons, octagons, cones, spheres, and cylinders

17: *Comparisons*

Comparisons of items and quantities that are: different, pairs, twins, belong together, tall, short, long, larger, and smaller numbers

18: *Direction and Position*

Recognition of the direction and position of right, left, up, down, top, bottom, middle, inside, outside, first, next, last, front, and back

19: *Graphs*

Read and complete bar graphs and pictographs

20. *Measurement*

Reading lengths in inches and centimeters, perimeter in inches

21. *Units of Measure*

Identify and count cups, quarts, gallons, and liters

22. *Fractions*

Recognition of whole, $\frac{1}{2}$, $\frac{1}{4}$, and $\frac{1}{3}$

23. *Sequence*

Determine what comes next

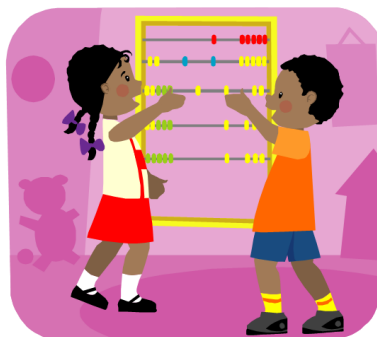

Science

The Science curriculum is based on Harcourt School Publishers *Science Fusion* (©2017.) Students will use a “hands-on” approach to learning.

Unit 1: *Doing Science*

Our Senses
Science Skills
Science Tools

Unit 7: *Energy*

Sound
Light
Heat

Unit 2: *Motion*

Where Things Are
How Things Move
Changing How Things Move
Magnets

Unit 8: *Animals*

Living and Nonliving
Real and Pretend
Many Animals
What Animals Need
Animals Grow and Change

Unit 3: *Day and Night*

Day Sky
Night Sky

Unit 9: *Plants*

Many Plants
What Plants Need
Plant Parts
Plants Grow and Change

Unit 4: *Magnets*

Unit 5: *Weather and the Seasons*

Weather
Measuring Weather
Seasons

Unit 10: *Habitats*

Homes for Living Things
Animals and Plants Together

Unit 6: *Matter*

Matter
Matter Can Change
Heating and Cooling Matter

Unit 11: *Earth's Resources*

Rocks
Water
Natural Resources



Social Studies

The Social Studies curriculum is based on Harcourt School Publishers *Into Social Studies* (©2017.)

Unit 1: *Being a Good Citizen*

- Together
- Getting Along
- Rules at School
- Solving Problems
- Malala Yousafzai
- Being a Good Citizen in Your Neighborhood
- It's the Law
- Great Citizens



Unit 4: *Maps*

- Maps and Models of a Classroom
- Directions on the Playground
- Maps
- Around the Neighborhood
- Mapping a Fairy Tale: Little Red Riding Hood
- Map of My Country
- Our World

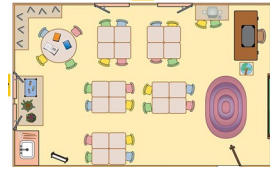

Unit 2: *Flags and Other Symbols*

- The Flag We Wave
- Our National Anthem
- The Liberty Bell
- The Bald Eagle
- Mt. Rushmore
- The Statue of Liberty
- Our Capital City
- State Flags and Symbols

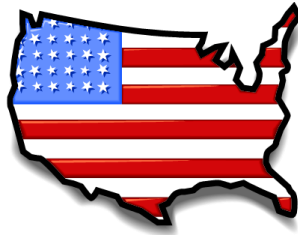

Unit 5: *Neighborhoods*

- Our Neighborhood
- Water and Land
- Getting Around
- Shopping and Eating
- Neighbors Get Together
- Neighbors to the Rescue
- School
- Neighborhoods Now and Then
- Building a Town



Unit 3: *Jobs*

- Jobs at School
- Your Job at School
- Community Workers
- Worker Animals
- Workers Solve Problems
- Jobs Today and Long ago
- Why People Work
- Goods and Services
- Making Choices When Spending Money



Unit 6: *Past and present*

- It's About Time: Timelines
- Calendars
- Holidays
- Changes Over Time
- Food and Water
- At Home
- Fun and Games
- Going Places
- Schools
- In the Community

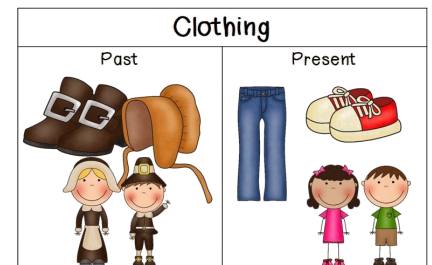

The Kindergarten students enrolled at Calvary Early Learning Center will also have special subjects throughout the week.

Music

Students have music every other week. Classes are taught by our classroom teachers. (We use music and songs in all other curricula areas.) The music curriculum for Kindergarten includes:

- Introduction to composers
- Introduction to instruments
- Rhythm
- Notation
- Song
- Dance
- Performance



Spanish

The Kindergarten students are introduced to the Spanish language throughout the week. Students learn simple conversational phrases; days of the week, months of the year, colors, numbers, and other introductory Spanish vocabulary.



Art

Art activities are included in daily classwork. Coloring, painting, cutting, gluing are all aspects of the art curriculum. Specific art time is scheduled twice a week.

Physical Education

Physical activity is very important at any age. The Kindergarten students at Calvary Early Learning Center will exercise daily through free play at recess. This may be outside on the playground, or if the weather is inclement, we will be inside in the fellowship hall. The Physical Education curriculum includes introduction to sports and games; throwing, catching, and kicking skills; bike riding and safety. Good sportsmanship is a concept we discuss all year long.



Additional Themes Throughout the Year

Different themes and concepts overlap in the curriculum during the year. (For example, weather is a topic in reading, science, and social studies, but at different times during the year.) Review and repetition are essential to learning at this age. In addition to the topics, themes, and units already identified in this curriculum guide, the Kindergarten class will also study other themes periodically. These will include:

Apples
Autumn (Fall)
Christopher Columbus
Pumpkins
The First Thanksgiving
Christmas with Jesus
Christmas Around
the World

Winter
Health and Safety
Martin Luther King, Jr.
Ground Hog Day
Valentine's Day
Presidents
Teeth

Dr. Seuss
St. Patrick
Spring
Easter
Seeds/plants
Moms and Dads
Summer

Monday

Doors Open at 8:45 a.m.; Free Play until 9:15 a.m.

Morning Meeting, Pledges, Calendar, How many days of school?
9:20 -- 9:35 a.m.

Jesus Time until 10:00 a.m.

Pray, Clean hands, Snack until 10:15 a.m.

Reading and Handwriting until 10:55 a.m.

Math until 11:25 a.m.

Pray, Clean Hands, and Eat Lunch in Fellowship Hall until Noon

Recess until 12:25 p.m.

Read Aloud until 12:55 p.m.

Science until 1:25 p.m.

Social Studies until 1:50 p.m.

Pack up and get ready to go home at 1:50 p.m.

Tuesday

Doors Open at 8:45 a.m.; Free Play until 9:15 a.m.

Morning Meeting, Pledges, Calendar, How many days of school?
9:20 -- 9:35 a.m.

Jesus Time until 10:00 a.m.

Pray, Clean hands, Snack until 10:15 a.m.

Reading and Handwriting until 10:55 a.m.

Math until 11:25 a.m.

Pray, Clean Hands, and Eat Lunch in Fellowship Hall until Noon

Recess until 12:25 p.m.

Read Aloud until 12:55 p.m.

Art until 1:30 p.m.

Social Studies until 1:50 p.m.

Pack up and get ready to go home at 1:50 p.m.

Wednesday

Doors Open at 8:45 a.m.; Free Play until 9:15 a.m.

Morning Meeting, Pledges, Calendar, How many days of school?
9:20 -- 9:35 a.m.

Jesus Time until 10:00 a.m.

Pray, Clean hands, Snack until 10:15 a.m.

Reading and Handwriting until 10:55 a.m.

Math until 11:25 a.m.

Pray, Clean Hands, and Eat Lunch in Fellowship Hall until Noon

Recess until 12:25 p.m.

Chapel and Music or Read Aloud until 1:15 p.m.

Science until 1:25 p.m.

Social Studies until 1:50 p.m.

Pack up and get ready to go home at 1:50 p.m.

Thursday

Doors Open at 8:45 a.m.; Free Play until 9:15 a.m.

Morning Meeting, Pledges, Calendar, How many days of school?
9:20 -- 9:35 a.m.

Jesus Time until 10:00 a.m.

Pray, Clean hands, Snack until 10:15 a.m.

Reading and Handwriting until 10:55 a.m.

Math until 11:25 a.m.

Pray, Clean Hands, and Eat Lunch in Fellowship Hall until Noon

Recess until 12:25 p.m.

Read Aloud until 12:55 p.m.

Science until 1:25 p.m.

Art until 1:50 p.m.

Pack up and get ready to go home at 1:50 p.m.

Friday

Doors Open at 8:45 a.m.; Free Play until 9:15 a.m.

Morning Meeting, Pledges, Calendar, How many days of school?
9:20 -- 9:35 a.m.

Jesus Time until 10:00 a.m.

Pray, Clean hands, Snack until 10:15 a.m.

Reading and Handwriting until 10:55 a.m.

Math until 11:25 a.m.

Pray, Clean Hands, and Eat Lunch in Fellowship Hall until Noon

Recess until 12:25 p.m.

Read Aloud until 12:55 p.m.

Science until 1:15 p.m.

Let's Find Out until 1:30 p.m.

Pack up and get ready to go.

Something from Home